



Remote Transmitter Instructions

SUNSETTER ESSENTIALS MOTORIZED AWNINGS

For Technical Support:

[HTTPS://SUPPORT.SUNSETTER.COM](https://support.sunsetter.com)

E-MAIL CONTACTUS@SUNSETTER.COM

CALL TOLL FREE 800-670-7071

WARNING

**FAILURE TO FOLLOW THESE INSTRUCTIONS COULD RESULT
IN SERIOUS PERSONAL INJURY, INCLUDING DEATH.**

WARNING



- Remove and immediately recycle or dispose of used batteries according to local regulations and keep away from children. Do NOT dispose of batteries in household trash or incinerate.
- Even used batteries may cause severe injury or death.
- Call a local poison control center for treatment information.
- Applicable to compatible battery type **CR2430, CR2032, and CR2450.**
- Nominal battery voltage is **3V.**
- Non-rechargeable batteries are not to be recharged.
- Do not force discharge, recharge, disassemble, heat above **60° C** or incinerate. Doing so may result in injury due to venting, leakage or explosion resulting in chemical burns.
- Ensure the batteries are installed correctly according to polarity (+ and -).
- Do not mix old and new batteries, different brands or types of batteries, such as alkaline, carbon-zinc, or rechargeable batteries.
- Remove and immediately recycle or dispose of batteries from equipment not used for an extended period of time according to local regulations.
- Always completely secure the battery compartment. If the battery compartment does not close securely, stop using the product, remove the batteries, and keep them away from children.



Multi-channel remote transmitter

Parts Supplied

- Remote Transmitter and Wall Post

Tools Needed

- Pointed Tool (paper clip, toothpick, etc.) to press recessed Programming Button on rear of Remote

Figure 1

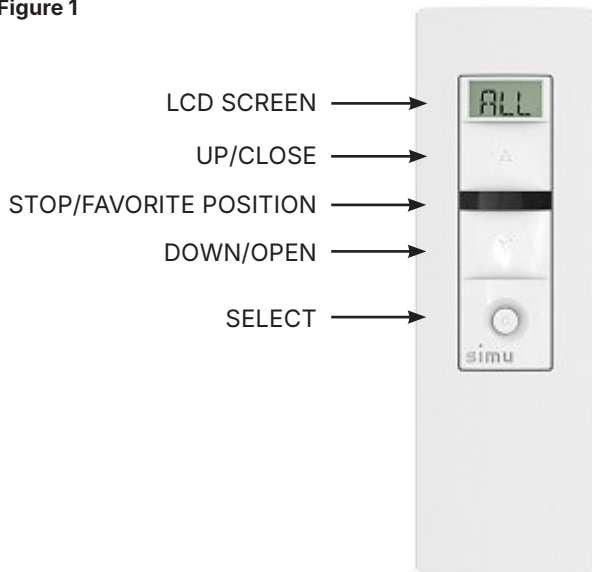

Your motorized awning is programmed at the factory to respond to channel 1 on the multi-channel remote transmitter packaged with your awning.

Each channel on every multi-channel remote (see **Figure 1**) has a unique ID (identification code) that allows your remote to act as 5 different remotes.

To change the active channel, press the channel selector button. The channel number will display on the LCD screen. Repeat pressing the channel selector button to move from channel 1 through channel 5 (labeled "ALL").

The motor in your awning can be programmed to respond to any or all of the 5 channels of the remote.

Notes:

- Each channel can be added to any number of different motors, so one multi-channel remote can control multiple awnings, independently.
- Multiple channels or remotes can be added to any one motor. This way, the user can control the awning from more than one channel, on the same or on more than one multi-channel remote.
- If only one channel operates the motor, this one channel cannot be deleted from the motor's memory.
- When programming multiple motors and remotes, always unplug all SunSetter products and plug in **ONLY** the one particular product you wish to program for the remote, at that time. This simplifies the process and reduces errors regarding which remote operates which product.

Use Section A to add an additional remote.

Use Section B to replace a missing or damaged remote.



Section A

ADD OR DISABLE ADDITIONAL REMOTE

ADDING ADDITIONAL REMOTE TRANSMITTERS OR CHANNELS TO THE MOTOR

1. Use the remote that currently controls the motor and confirm it is on the correct channel.
2. Press and hold the Program button until the motor gives a short back and forth jog.
3. Confirm remote is on the channel you wish to add and press the Program button.
The motor will give a short back and forth jog.
4. The new channel is now added. Repeat for any additional remote channels you wish to add.

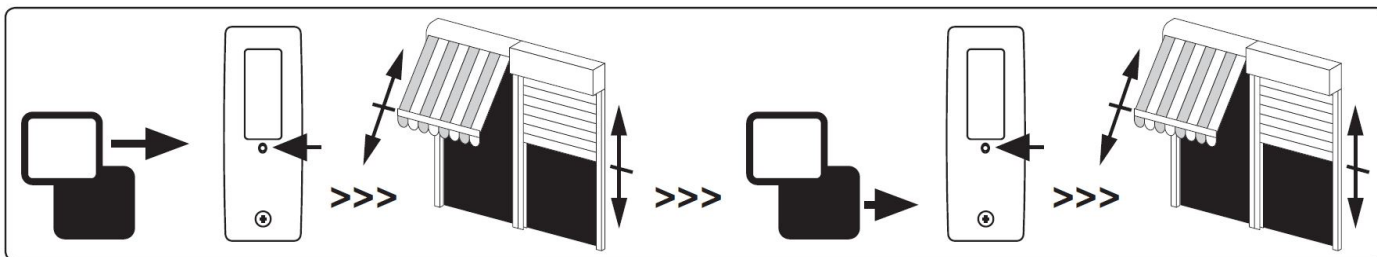

DELETING A REMOTE TRANSMITTER OR CHANNEL FROM A MOTOR

1. Use a remote that currently controls the motor and confirm it is on the correct channel to control the motor.
2. Press and hold the Program button until the motor gives a short back and forth jog.
3. Press the Program button of the second remote/channel until the motor gives a short back and forth jog. The second remote/channel is now deleted.

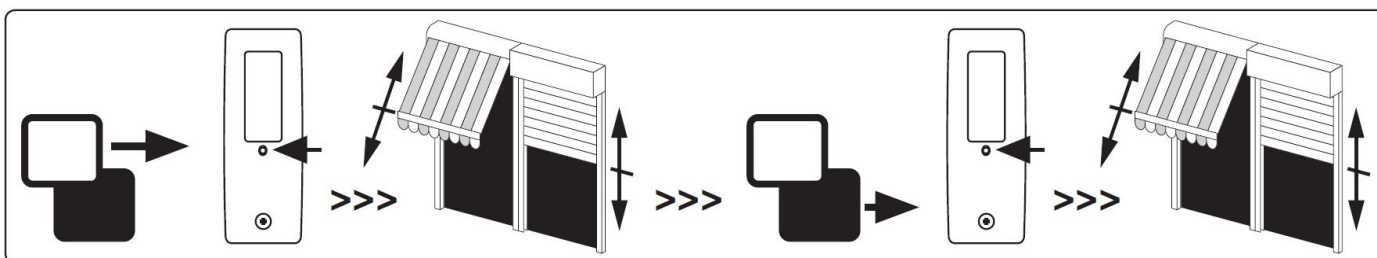



Section B

REPLACE REMOTE

CLEARING THE MEMORY OF ALL OLD TRANSMITTERS AND ADDING NEW TRANSMITTERS

If all motor transmitters are lost or damaged, it is possible to clear the old memorized codes from memory and add the new transmitter. Perform a double power cut in the following sequence:

1. Power off for at least 8 seconds
2. Power on for 8 seconds
3. Power off for at least 8 seconds
4. Power on. The motor will try and run for 5 seconds but will not run past its limits.

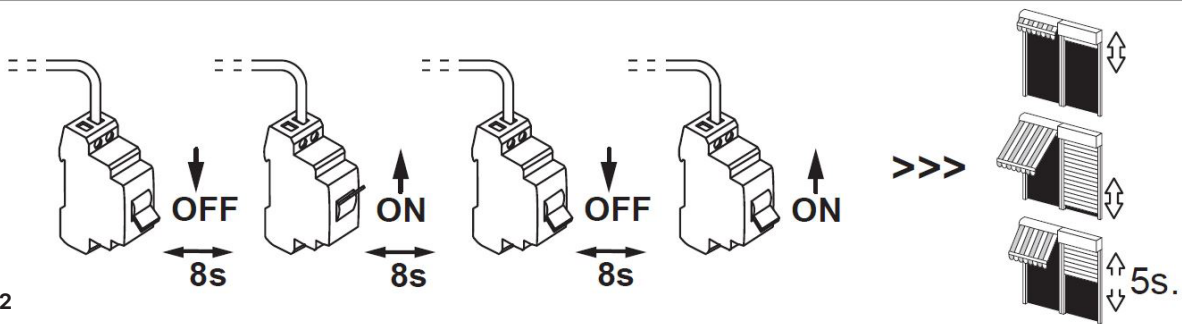

Figure 2

The motor is now in a **temporary mode for 2 minutes**. **NOTE: this is not the “factory mode”**. If a motor or motors are entered into temporary programming mode by mistake it can be canceled by pressing, for a second, on the UP/CLOSE, STOP or DOWN/OPEN of any transmitter that motor has memorized. The motor will also return to normal operating mode if left for 2 minutes.

5. Press and hold the Program Button of any unmemorized transmitter for **more than 8 seconds**. When the motor gives a short up/down bounce release the button. The memory of the motor's receiver is now cleared of the old transmitters and the new transmitter has been added.



Installing the remote wall post

We have supplied a wall holder for the remote (see **Figure 3**). Simply position the wall holder at the desired location, mark the hole locations and secure with the supplied hardware, if needed.

CAUTION

Do not permit the hand-held remote transmitter to get wet, as this can affect its proper operation.

It is recommended to install the wall holder inside the house.

Figure 3

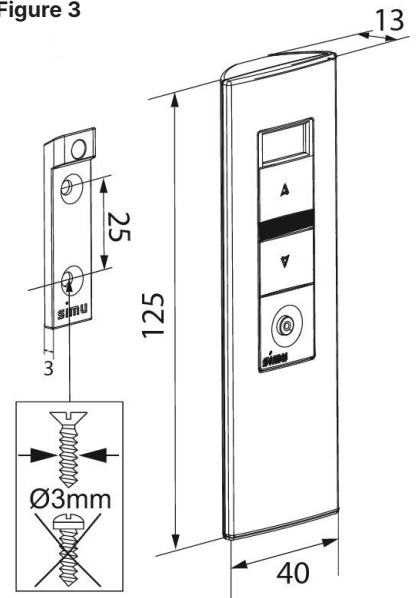

Changing the remote battery

Replace the battery when the low battery indicator light comes on.

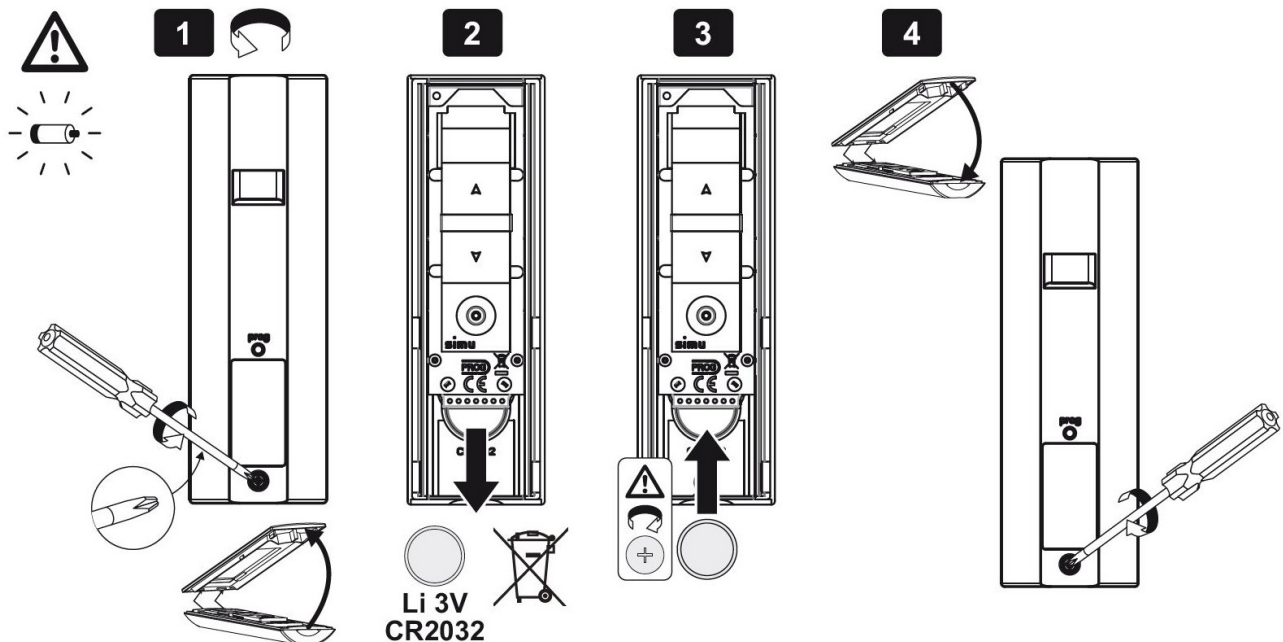

Thank you for choosing SunSetter.