



America's #1 Awning

For Technical Support visit us at [ownerscorner.sunsetter.com](http://ownerscorner.sunsetter.com)  
or Call Toll Free 800-670-7071 • Fax 877-224-4944

## Left Roller Insert Replacement Model 900XT & 1000XT

**Tools Needed:** Small nail or punch, hammer,  $\frac{7}{32}$ " Allen wrench, flat screwdriver, Phillips screwdriver.

**Parts Supplied:** Left Roller Insert (See Figure 1), (3) Plastic Screw Anchors ( Anchors are 3 legged with  $\frac{1}{2}$ " square head), and (6) Phillips screws (#8 x  $\frac{5}{8}$ " )

**WARNING:** FAILURE TO FOLLOW THESE INSTRUCTIONS CAN RESULT IN PERSONAL INJURY!! PLEASE READ THESE INSTRUCTIONS IN ITS ENTIRETY BEFORE ATTEMPTING TO COMPLETE THIS PROCESS.

Figure 1

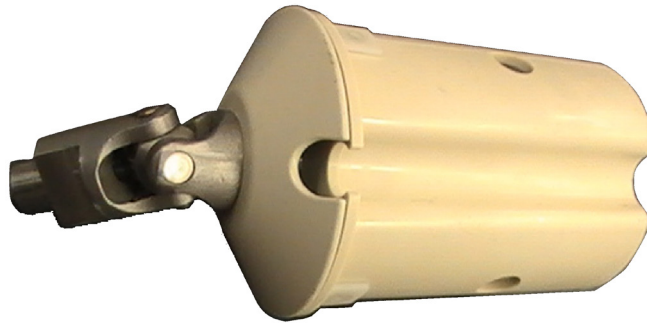

**PLEASE NOTE THAT LEFT AND RIGHT REFERENCES ARE AS YOU ARE FACING THE HOUSE.**

- Using the Hand Crank, unroll the Awning until the Fabric is completely extended. Do not lock the Rafters. Place a chair or box under the Roller Bar for support.
- If your Roller has 3 Phillips Screws that secure the left Roller Insert to the Roller Bar, complete Steps 2 - 5.**
- If your Roller has Drive Rivets that secure the left Roller Insert to the Roller Bar, complete steps 6 - 11.**

- Remove the 3 Phillips screws from the left end of the Roller Bar.
- Pull the Roller Insert out of the Roller Bar.
- Using a  $\frac{7}{32}$ " Allen wrench, remove the Flat-head Cap Bolt (see **Figure 2**) that secures the Arm and Rafter to the Roller Bar Assembly.
- Separate the Left Roller Insert from the ends of the Rafter and Arm.

**Go to Step 12.**

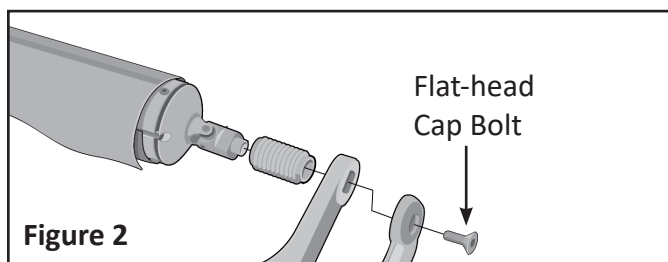

- On the left end, using a small nail or punch, drive the centers of the three rivets all the way thru into the Roller Bar.
- Pry the rivets out of the holes with a flat screwdriver
- Pull the Left Roller Insert out of the Roller Bar.
- Remove the rivet centers from inside the Roller Bar or they will rattle when you operate the Awning.
- Using a  $\frac{7}{32}$ " Allen wrench, remove the Flat-head Cap Bolt (see **Figure 2**) that secures the Arm and Rafter to the Roller Bar Assembly.
- Separate the Left Roller Insert from the ends of the Rafter and Arm.

**Go to Step 12.**

12. Insert the new Left Roller Insert into the Roller Bar and secure by installing the supplied Phillips screws into the three holes on the end of the Roller Bar.
13. Assemble the ends of the Rafter and Arm to the Roller Bar and secure with the Flat-head Cap Bolt (see **Figure 2**). Tighten with a  $\frac{7}{32}$ " Allen wrench.
14. Check the opposite side of the Roller Bar;
  - a. If the Drive Unit on the right side of the Roller is secured to the Roller Bar with 3 Drive Rivets, follow **Steps 15 a through f**, replacing the Rivets with the 3 Phillips screws and Plastic Anchors supplied with the Left Roller Insert.
  - b. If the Drive Unit on the right side of the Roller is secured to the Roller Bar with 3 Phillips screws, go to **Step 16**.

**WARNING: FAILURE TO REPLACE THE 3 DRIVE RIVETS ON THE RIGHT SIDE OF THE ROLLER BAR CAN RESULT IN PERSONAL INJURY!**

15. Replace the Drive Rivets on the right side of the Roller Bar:
  - a. Make sure that the Fabric is completely extended. Do not lock the Rafters.
  - b. Place a chair or box under the Roller Bar for support.
  - c. On the right side of the Roller Bar, using a small nail or punch, drive the centers of the three Rivets all the way through, into the Roller Bar. Pry the rivets out of the holes with a flat screwdriver.
  - d. Pull the Drive Unit out of the Roller Bar. Remove the Rivet centers from inside the Roller Bar, or they will rattle when you operate the Awning.
  - e. On the Drive Unit, locate the three holes close to the end and snap the 3 Plastic Screw Anchors supplied into the holes from the outside.

**CAUTION: Be sure that the Screw Anchors are pressed firmly into the holes.**
  - f. Insert the Drive Unit back into the Roller Bar. Secure by installing the supplied Phillips screws into the three holes on the end of the Roller Bar.
16. Test the Awning for proper operation.