



RETRACTABLE AWNINGS

For Technical Support visit us at [www.sunsetter.com/ownerscorner](http://www.sunsetter.com/ownerscorner)  
or Call Toll Free 800-670-7071 • Fax 877-224-4944

## Weatherbreaker Side Panel for Motorized PRO Awning Installation Instructions

**Tools Needed:** Pencil, 1/8" Drill Bit, Electric Drill, Step Ladder, Measuring Tape, Hammer, Phillips Screw Driver.

**For masonry installation:** 3/16" Masonry Drill Bit.

**Parts Enclosed:** Weatherbreaker Side Panel, four (4) Attachment Hooks, four (4) Mounting Screws, two (2) Cords, one (1) Cord-Lock (Housing Gear), two (2) 3/16" Plastic Anchors.

**CAUTION: FAILURE TO WEAR SAFETY GLASSES OR TO FOLLOW THE INSTRUCTIONS BELOW CAN RESULT IN PERSONAL INJURY!**

**1.** Mark a level horizontal line extending from the Top Bolt Hole of the Wall Bracket to 1" beyond the end of the Square Bar of the Awning. See **Figure 1**.

**2.** Draw a vertical line extending up from the end of the Square Bar that intersects with the horizontal line that you marked in **step 1**. See **Figure 1**.

**Note:** If a Hood is installed, move this vertical line to the inside of the Hood End Plate.

See **Figure 1**.

**3.** At the intersection,

**For Wood frame installation:** drill a 1/8" pilot hole approximately 1-1/2" deep.

**For Masonry installation:** drill a 3/16" hole approximately 1-1/2" deep. Insert a supplied Plastic Anchor into the hole and drive it flush with a hammer.

**4.** Attach the attachment hook by securing with the supplied screw.

**5.** Tie one of the supplied cords to the Panel as shown. See **Figure 2**.

**6.** Slide the two ends of the second Cord through the Cord-lock from the smaller (flat edge) side to the larger (curved) side. (Do not pull the entire cord through). Hold the Cord-lock in the center of the Cord and separate the two ends of the Cord. See **Figure 3**.

**7.** Slide the White Round Gear into the large (curved) open end of the Cord-lock housing until the gear pops into place. Be sure that the part of the gear that protrudes is aligned with the slot in the Cord-lock housing. Tie the two ends of the Cord so that they cannot slide back through the Cord-lock. Slide the Cord-lock all the way towards the knot on the Cord.

*Continued on next page...*

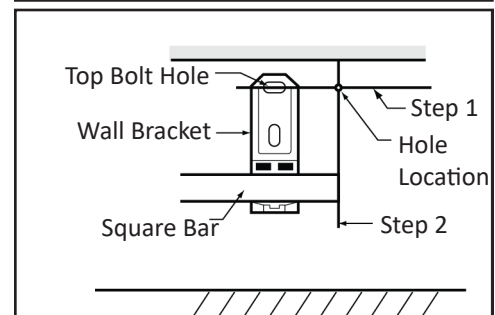
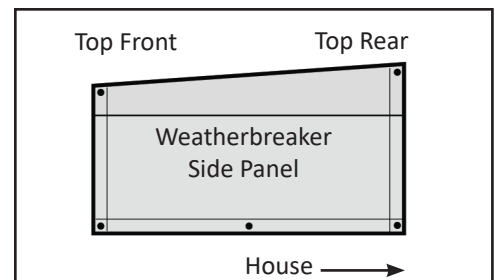

Figure 1

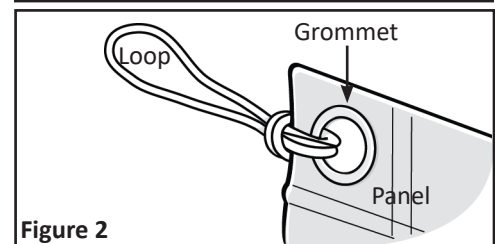

Figure 2

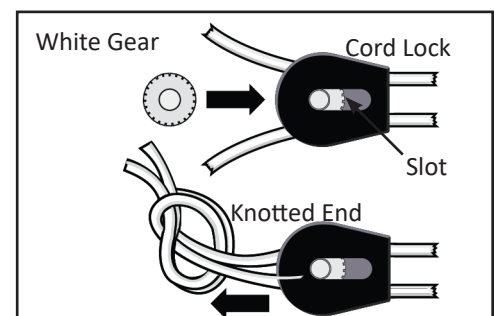
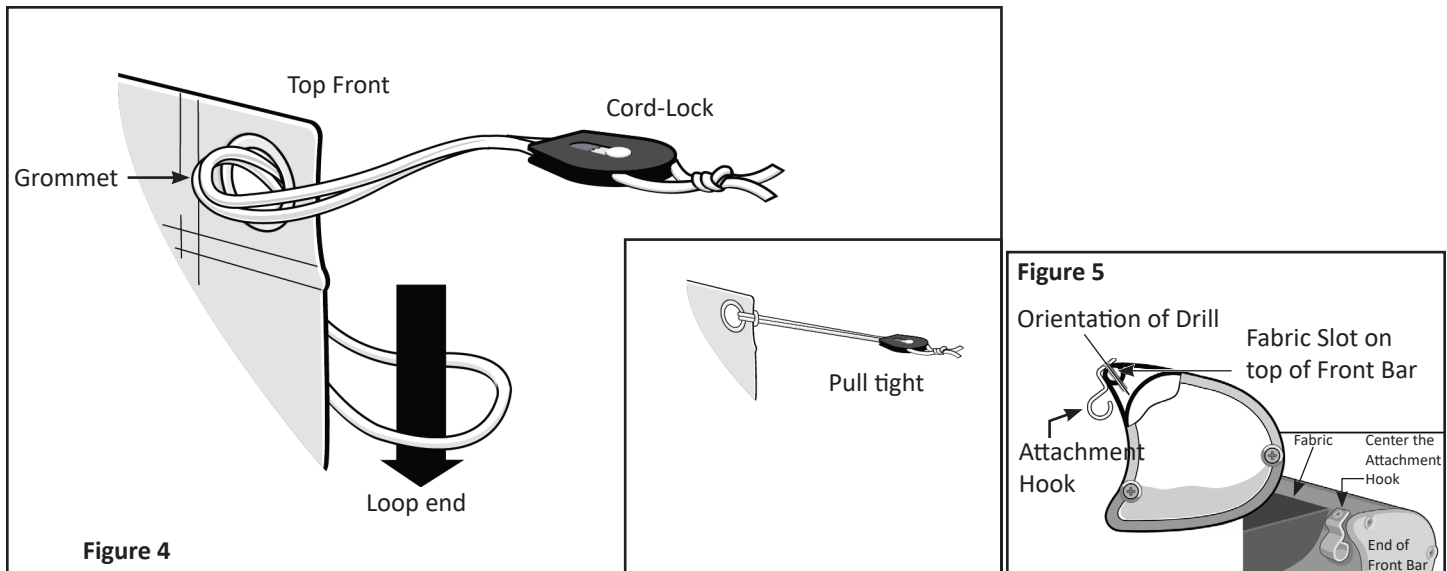

Figure 3



**8.** Slide the loop end of the Cord through the Top Front Grommet as shown, outside of arc to inside of arc. See **Figure 4**.

**9.** Slide the Knotted End of Cord and the Cord-lock through the loop of Cord on the other side of the Grommet as shown in **Figure 4**. Pull the rope tight.

**10.** Locate the Fabric Slot on the top of the Front Bar. See **Figure 5**.

**11.** Using the Attachment Hook as a template, set the flat surface of the Hook over the Fabric Slot, centered between the Fabric and the end of the Front Bar. See **Figure 5**.

**12.** With a Pencil, mark the location of the hole in the Attachment Hook on the Front Bar.

**Note: Position the drill to ensure that you do not drill through the back wall of the Front Bar.**

**13.** Drill a  $\frac{1}{8}$ " hole approximately 1" deep in the Front Bar.

**14.** Place the Attachment Hook on the Front Bar and install using the supplied Screw. See **Figure 5**.

## Setup

- Place the loop of cord (attached to the Grommet on the back of the Panel) over the Hook that you installed on the wall.
- Insert the double cords that go through the cord-lock into the opening in the Attachment Hook on the Front Bar. Tighten the panel by holding the sides of the Cord-lock and pulling the Cord. The gear of the Cord-lock should move forward to hold the Cords at this point.

## Removal

- Slide the Gear of the Cord-lock back to loosen the Cord.
- Remove the Cords by sliding them out of the opening in the Attachment Hook.
- Remove the Cord loop from the Hook on the house.

**Note: Remove the Weatherbreaker panels before closing the Awning.**

**WARNING - DO NOT LEAVE YOUR MOTORIZED AWNING EXTENDED UNATTENDED OR DURING EXCESSIVE WINDY OR RAINY CONDITIONS.**